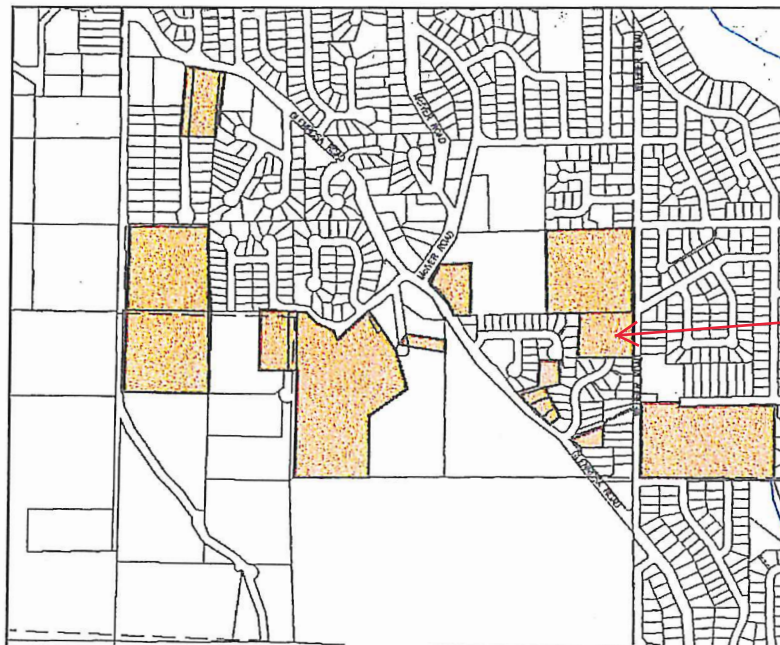

**Attachment 5 - CWK File: A 19-05****Agricultural Policy from Westside OCP Bylaw No. 1050****-replaced by West Kelowna OCP Bylaw No. 0100 in 2011**

- 2.14 Support applications for home site severances as defined by Agricultural Land Commission Homesite Severance Policy and Regional Board policy.
- 2.15 Discourage the proliferation of non-farm residential development or use. Accessory homes shall be limited to legitimate use by farm help.
- 2.16 Support parcels indicated for exclusion from the Agricultural Land Reserve based upon the completion of the review of the Westbank Town Centre Plan (as recommended by policy in this OCP)..
- 2.17 Consider applications to the Agricultural Land Commission for public use requirements such as school or parks where warranted by investigation, review of alternatives, and study of agricultural impact.
- 2.18 Require an Official Community Plan amendment to a designation other than "Agricultural" if land is excluded from the ALR in order for further development to occur.
- 2.19 Require land approved for non-farm uses by the Agricultural Land Commission to be rezoned in accordance with Zoning Bylaw No. 871. Such land uses are not considered approved by the Regional District until rezoned appropriately.
- 2.20 Consider land included into the ALR in accordance with the "Agricultural" designation policies in this OCP.
- 2.21 Support for exclusion from the Agricultural Land Reserve the isolated properties indicated on the following Figure No. 14.2 ALR Lands Supported for Exclusion. These properties were identified (through a general evaluation of the Westbank area conducted by the Agricultural Land Commission in the mid 1990's) as being of low value for retention in the Agricultural Land Reserve. **\*\*Related to ALC Resolution 1243/1993**

Bylaw  
1050-13**FIGURE 14.2 ALR LANDS SUPPORTED FOR EXCLUSION**CWK File: A-19-05  
Subject Property