

The Glenrosa Road & McIver Road intersection design resolves alignment and sight line restrictions by realigning the east leg of McIver Road and improving the roadway cross-section.

- Restricting movements at the intersection with a raised median. The solution was not selected due to the negative impact to access in the neighbourhood.
- A single lane roundabout was considered, but not selected since traffic volumes did not warrant the additional cost and difficulty to design in hillside terrain.

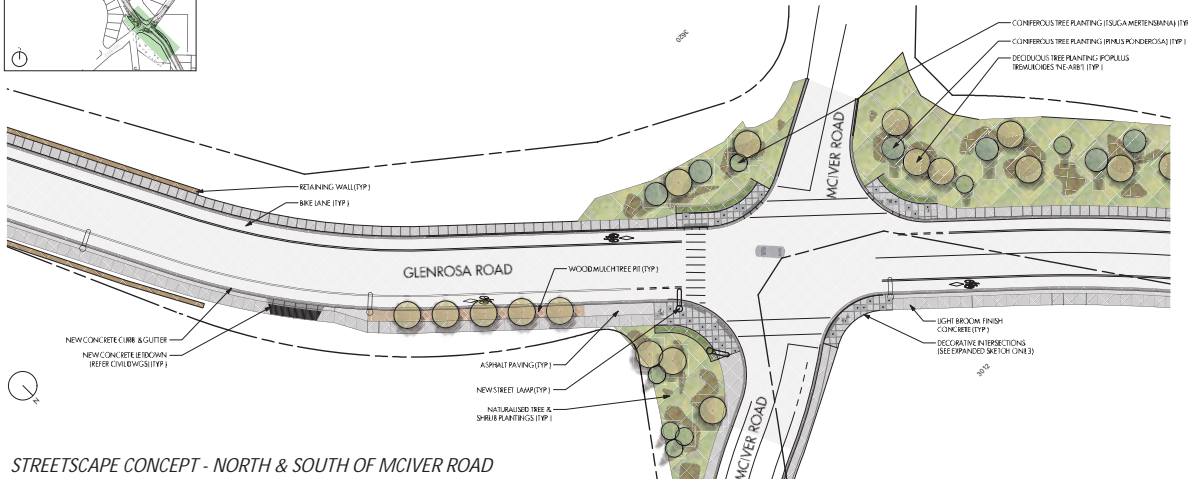

STREETSCAPE CONCEPT - NORTH & SOUTH OF MCIVER ROAD

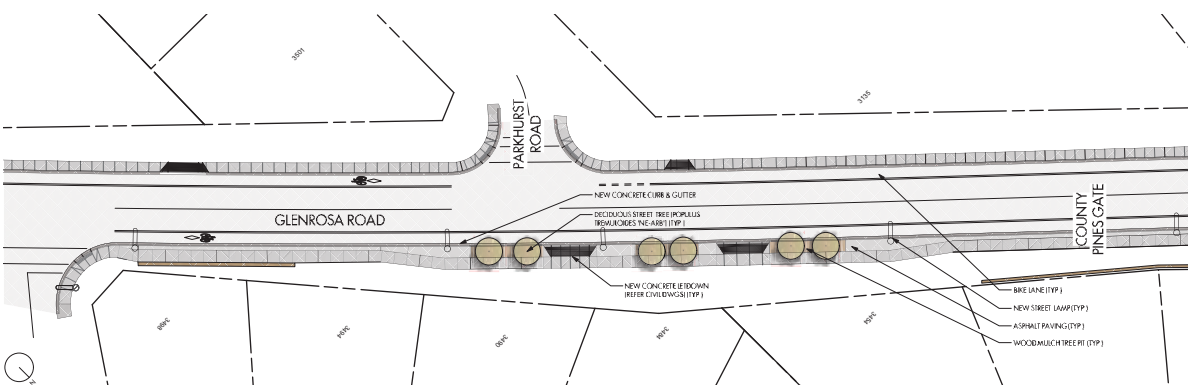

STREETSCAPE CONCEPT - MCGINNIS ROAD TO PARKHURST ROAD