



**CITY OF WEST KELOWNA
DEVELOPMENT VARIANCE PERMIT
DVP 20-02**

To: Zbigniew Chwala and Barbara Chwala
3640 Granada Crescent
West Kelowna, BC V4T 1J8

1. This Development Variance Permit is issued subject to compliance with all of the Bylaws of the City of West Kelowna applicable thereto, except as specifically varied or supplemented by this Permit.
2. This Permit applies to and only to those lands within the City of West Kelowna described below, and any and all buildings, structures and other developments thereon:

Lot 31, DL 3481, ODYD, Plan 26167

3. This Permit allows for the construction of a garage with a reduced interior side parcel boundary setback for a portion of the property line as shown on attached Schedule 'A'. Specifically, this Permit varies Zoning Bylaw No. 0154, Section 3.7.1(d) to reduce the interior side parcel boundary setback for an accessory building in excess of 2.0 m (6.6 ft) in height from 1.5 m to 0.45 m.
4. This Permit is subject to the following conditions:
 - a. All driveway accesses to the site shall be in general accordance with Traffic Bylaw No. 92, which will require revisions to the existing driveways and landscaping; and.
 - b. A separate Crossing Permit is required to address the proposed driveway locations, including the new access to the garage, prior to the issuance of any future building permits.
5. The land described herein shall be developed strictly in accordance with the terms and conditions of this Permit and any plans and specifications attached to this Permit, which shall form a part hereof.
6. **This Permit is not a Building Permit.**

AUTHORIZING RESOLUTION NO. _____, _____ PASSED BY THE MUNICIPAL COUNCIL ON _____, _____.

ISSUED ON _____, _____

Signed on _____, _____

City Clerk

Schedule A:

1. Site Plan
2. Elevations, Date Received Jun 1, 2020

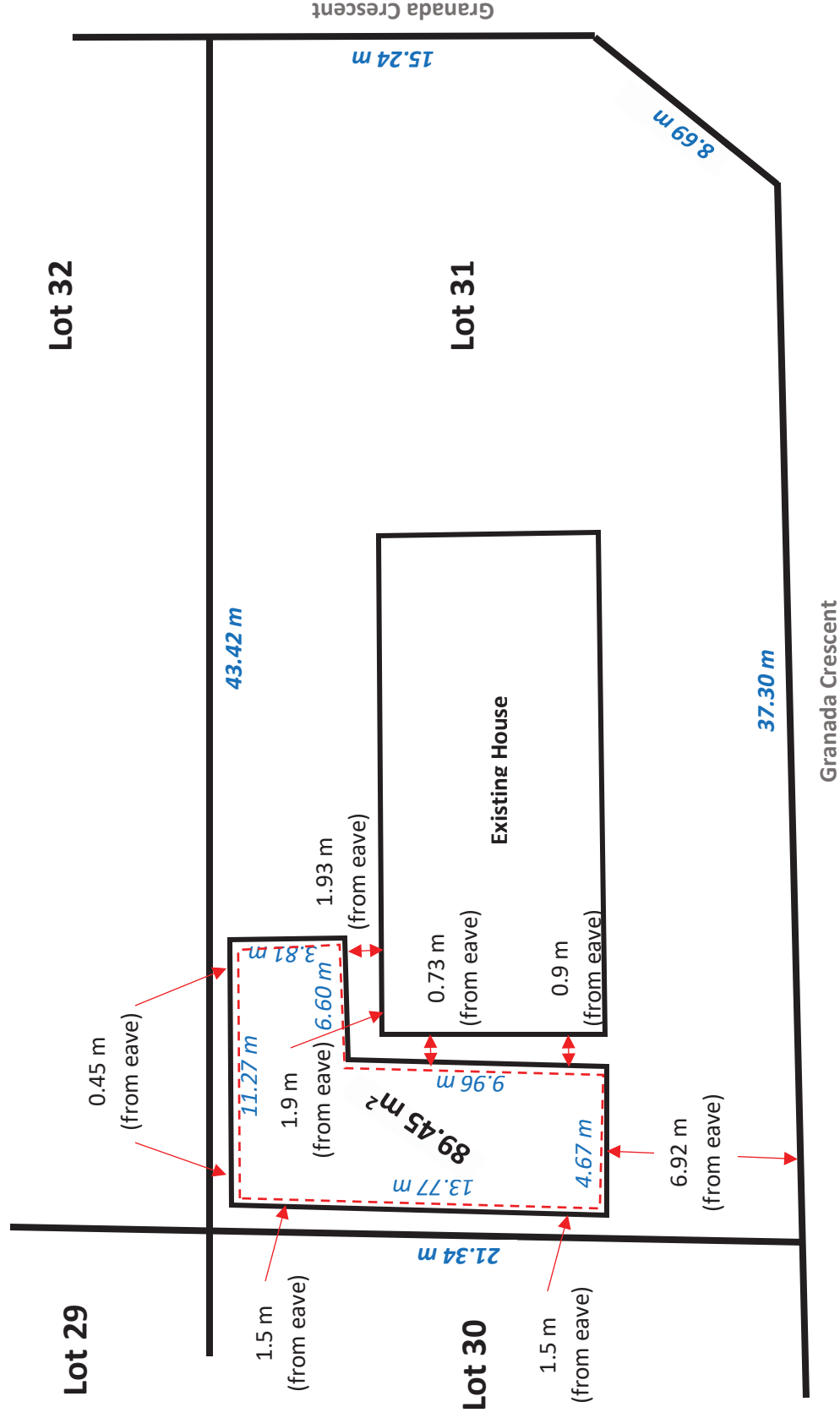

Proposed Garage – Building Measurements and Setbacks

Elevations

Date Received: Jun 1, 2020

Side Interior

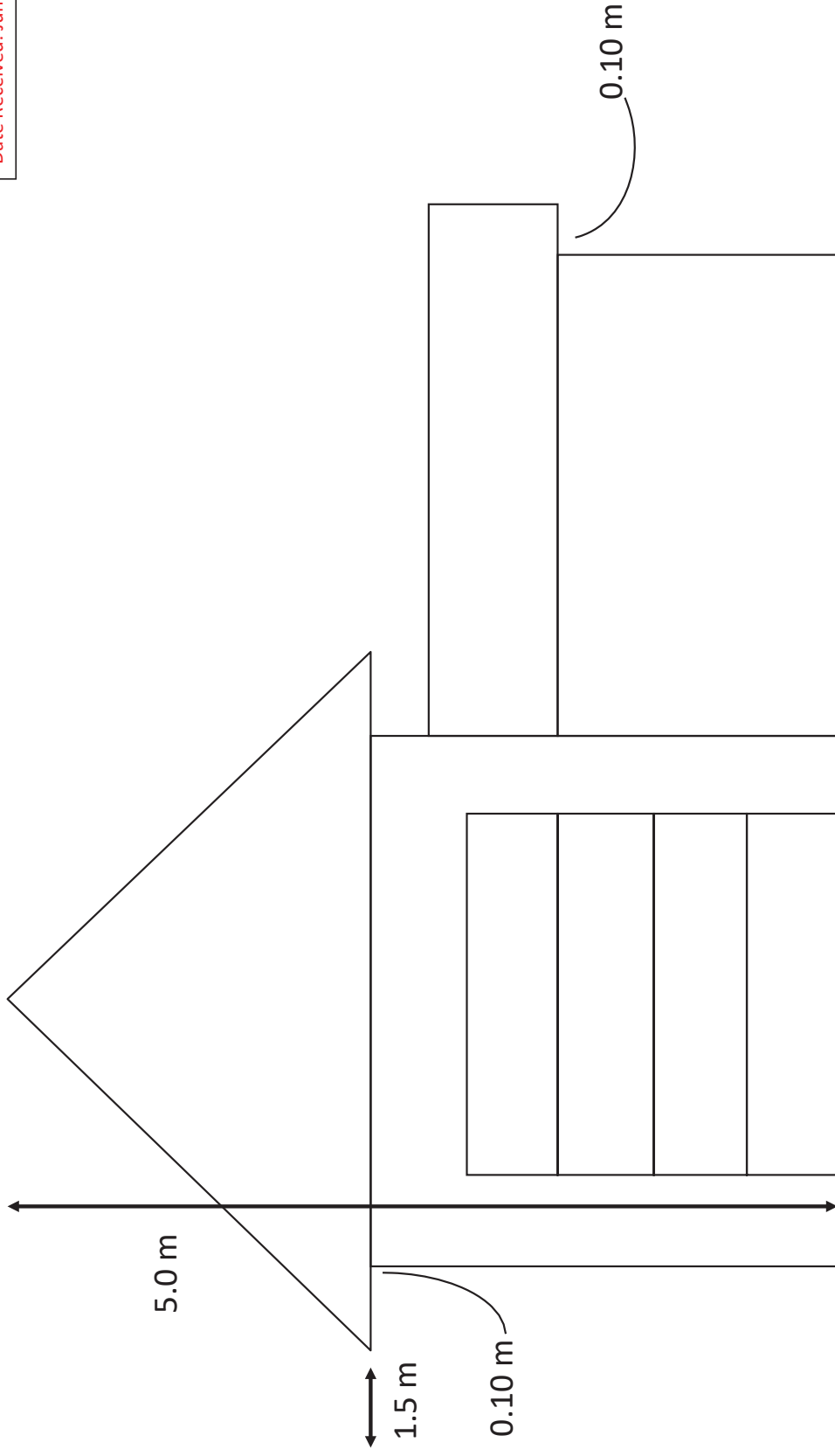

Rear

Rear

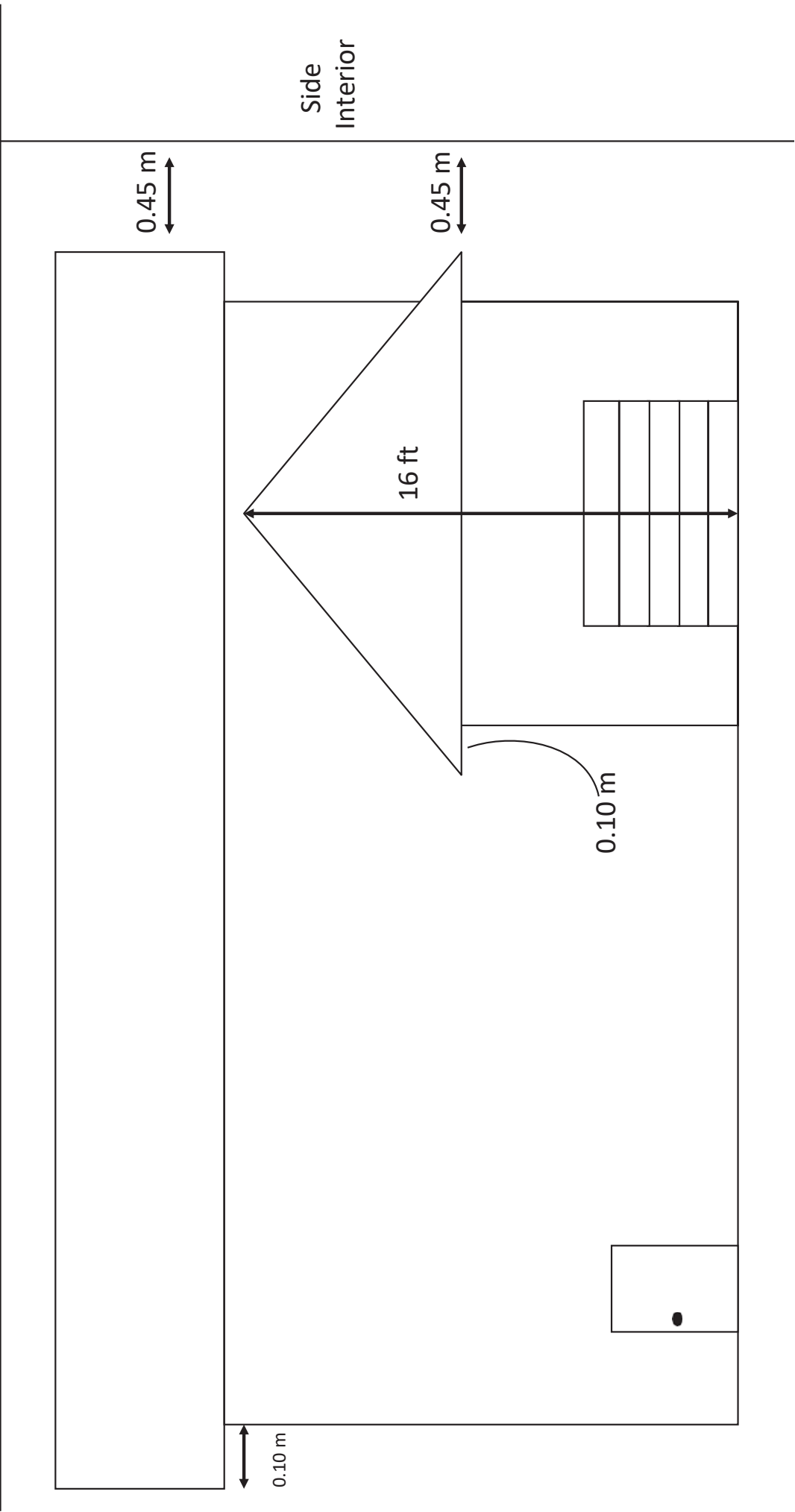

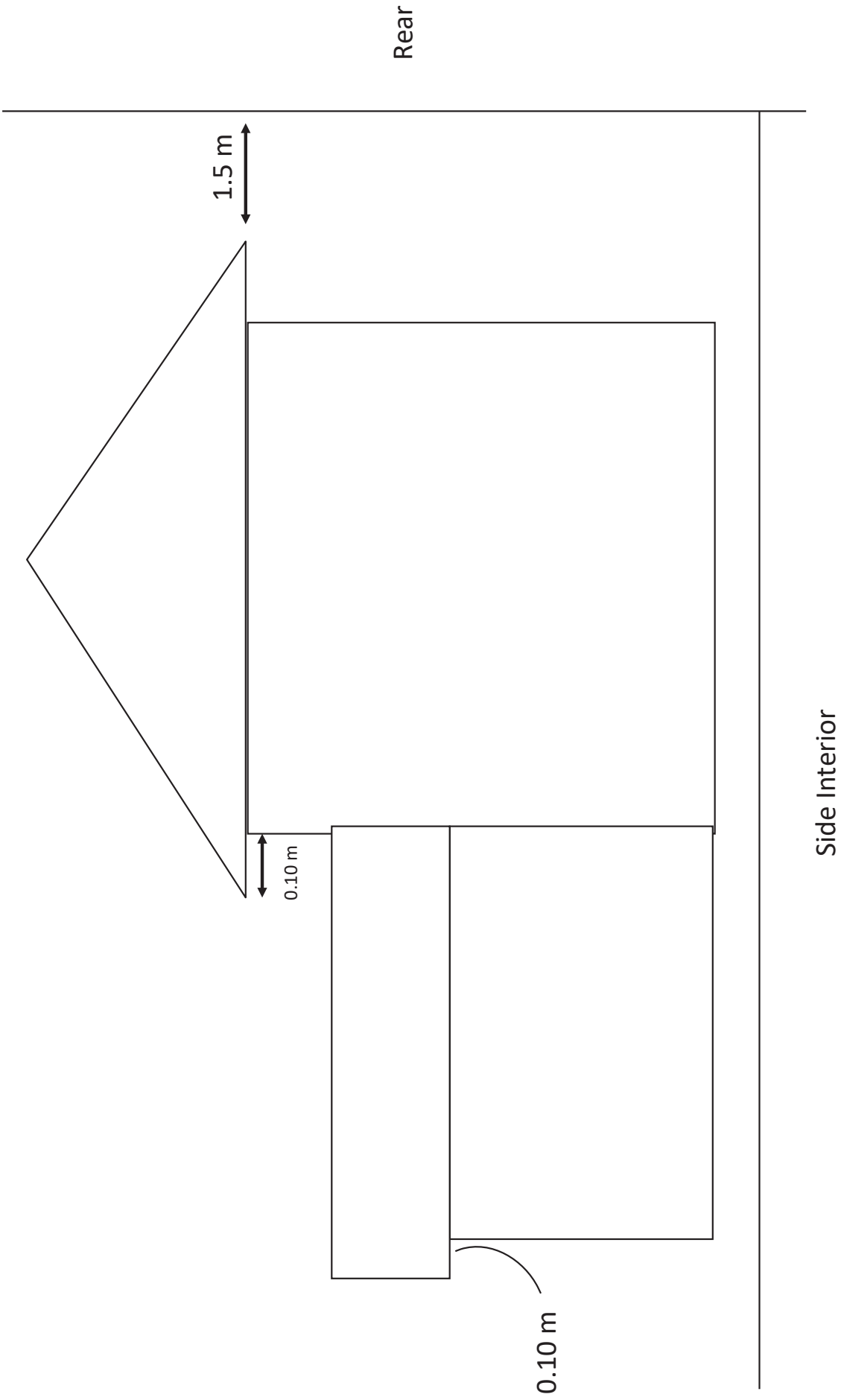

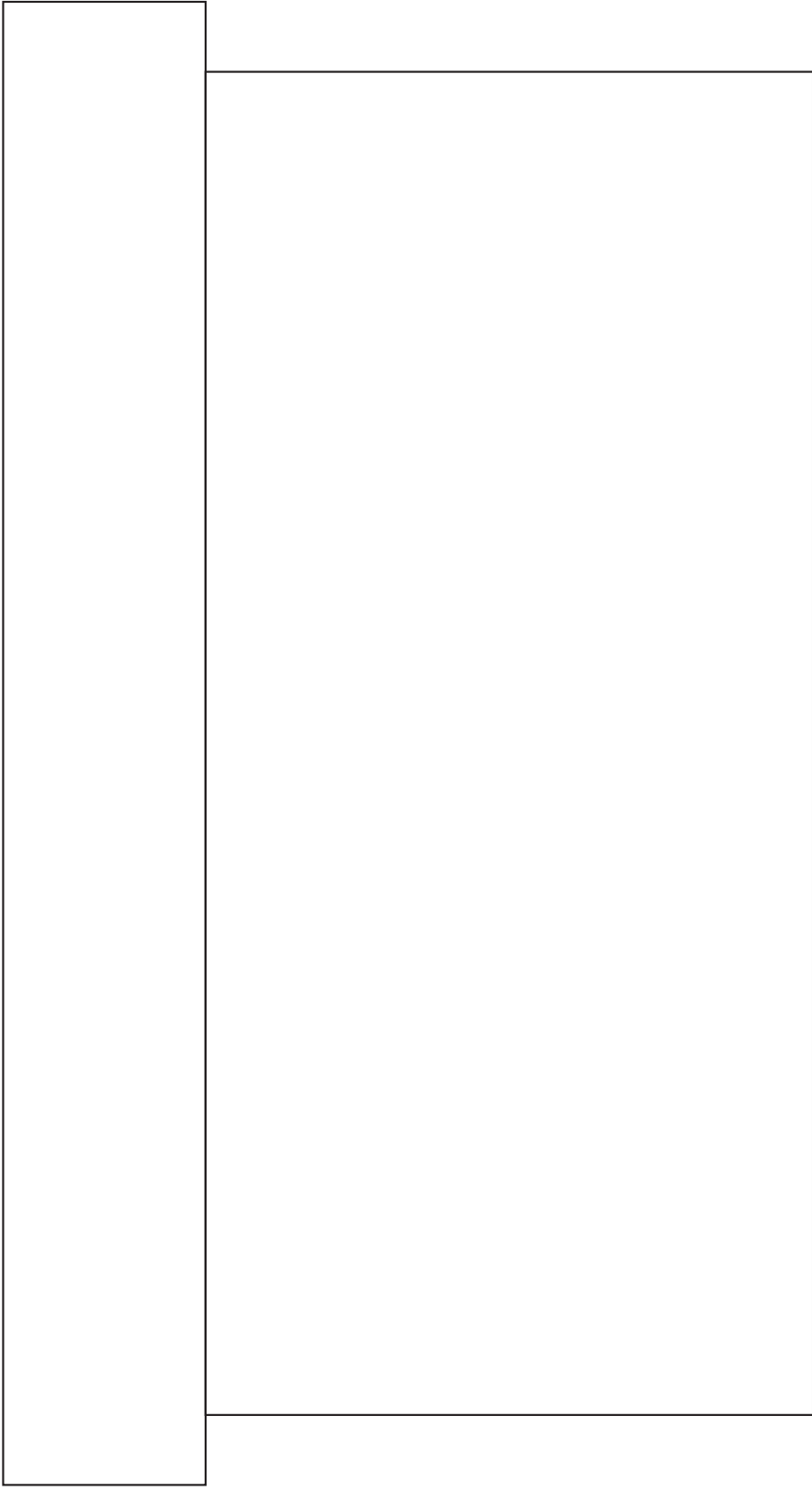

0.45 m

Side
Interior

Rear