



Bylaw No.
154.36

10.3. COMPACT SINGLE DETACHED RESIDENTIAL ZONE (RC3)

.1 Purpose

To accommodate single detached residential use on parcels of land that are 325 m² and larger.

.2 Principal Uses, Buildings and Structures

- (a) Single detached dwelling

.3 Secondary Uses, Buildings and Structures

- (a) Accessory uses, buildings and structures
- (b) Care facility, minor
- (c) Home based business, major
- (d) Secondary suite on parcels 550 m² (5,920.2 ft²) or greater

Bylaw No.
154.50

.4 Site Specific Uses, Buildings and Structures - *Reserved*

.5 Regulations Table

SUBDIVISION REGULATIONS		
(a)	Minimum parcel area	325 m ² (3,498.3 ft ²)
(b)	Minimum usable parcel area	195 m ² (2,099.0 ft ²)
(c)	Minimum parcel frontage	12.0 m (39.4 ft)
DEVELOPMENT REGULATIONS		
(d)	Maximum density:	
.1	Single detached dwelling	1 per parcel
.2	Secondary suite	1 per parcel
(e)	Maximum parcel coverage	40%
(f)	Maximum building height:	9.0 m (29.5 ft) to a maximum of 3 storeys except it is 5.0 m (16.4 ft) for accessory buildings and structures
SITING REGULATIONS		
(g)	Buildings and structures shall be sited at least the distance from the feature indicated in the middle column below, that is indicated in the right-hand column opposite that feature:	
.1	Front parcel boundary or private access easement, whichever is closer	3.5 m (11.5 ft) except it is 6.0 m (19.7 ft) for a garage or carport having vehicular entry from the front
.2	Rear parcel boundary or private access easement, whichever is closer	3.0 m (9.8 ft)
.3	Interior side parcel boundary	1.5 m (4.9 ft)

Bylaw No.
154.50

.4	Exterior side parcel boundary or private access easement, whichever is closer	2.5 m (8.2 ft) except it is 6.0 m (19.7 ft) for a garage or carport having vehicular entry from the exterior side
.5	Parcels in another zone	4.5 m (14.8 ft)
.6	A1 Zone or ALR	15.0 m (49.2 ft) except it is 9.0 (24.6ft) if a level 1 buffer is provided.

.6 Other Regulations

(a) Without limiting the application of the height regulation in Section 10.3.5(f), the height of any single building wall, measured from the lowest elevation of grade at the foot of the wall to the lower surface of the eave, or to the top of the wall in the case of a building without eaves, shall not exceed the lesser of 3 storeys or 9 m (29.5 ft).

(b) **Siting Regulations for Approved Subdivisions**

- .1 the regulations requiring a minimum distance between garages or carports having vehicular entry from parcel boundaries or private access easements, that is greater than the minimum distance required for other buildings and structures, and
- .2 the regulations requiring that the siting of a building or structure be determined in relation to the location of a private access easement, if it is closer to the building or structure than the relevant parcel boundary,

shall not apply to any parcel created by subdivision deposited in the Land Title Office before March 13, 2014 provided that the building permit authorizing the construction of the building or structure is issued before March 13, 2019.

Bylaw No.
154.06

Bylaw No.
154.36

10.4. SINGLE DETACHED RESIDENTIAL ZONE (R1)

.1 Purpose

To accommodate low density single detached residential use on parcels of land that are 550 m² and larger.

.2 Principal Uses, Buildings and Structures

- (a) Single detached dwelling

.3 Secondary Uses, Buildings and Structures

- (a) Accessory uses, buildings and structures
 (b) Bed and breakfast
 (c) Care facility, minor
 (d) Carriage house
 (e) Home based business, major
 (f) Secondary suite

.4 Site Specific Uses, Buildings and Structures

- (a) On Lot 1, Plan 44004, DL 581 ODYD, Except Plans KAP48178 & KAP53981: vineyard and one single detached/caretakers residence.

.5 Regulations Table

SUBDIVISION REGULATIONS		
(a)	Minimum parcel area	550 m ² (5,920.2 ft ²)
(b)	Minimum usable parcel area	330 m ² (3,552.1 ft ²)
(c)	Minimum parcel frontage	16.0 m (52.5 ft)
DEVELOPMENT REGULATIONS		
(d)	Maximum density:	
.1	Single detached dwelling	1 per parcel
.2	Secondary suite and carriage house	Only 1 secondary suite or only 1 carriage house per parcel
(e)	Maximum parcel coverage	40%
(f)	Maximum building height:	
.1	Single detached dwelling	9.0 m (29.5 ft) to a maximum of 3 storeys
.2	Accessory buildings and structures	5.0 m (16.4 ft)
.3	Carriage house	5.0 m (16.4 ft) to a maximum of 1 storey or 6.5 m (21.3 ft) to a maximum of 1.5 storeys where at least one parking stall is provided in the same building

SITING REGULATIONS		
(g)	Buildings and structures shall be sited at least the distance from the feature indicated in the middle column below, that is indicated in the right-hand column opposite that feature:	
.1	Front parcel boundary or private access easement, whichever is closer	4.5 m (14.8 ft) except it is 6.0 m (19.7 ft) for a garage or carport having vehicular entry from the front
.2	Rear parcel boundary or private access easement, whichever is closer	3.0 m (9.8 ft)
.3	Interior side parcel boundary	1.5 m (4.9 ft)
.4	Exterior side parcel boundary or private access easement, whichever is closer	4.5 m (14.8 ft) except it is 6.0 m (19.7 ft) for a garage or carport having vehicular entry from the exterior side
.5	A1 Zone or ALR	15.0 m (49.2 ft) except it is 9.0 (24.6ft) if a level 1 buffer is provided.

.6 Other Regulations

- (a) Without limiting the application of the height regulation in Section 10.4.5(f).1, the height of any single building wall, measured from the lowest elevation of grade at the foot of the wall to the lower surface of the eave, or to the top of the wall in the case of a building without eaves, shall not exceed the lesser of 3 storeys or 9 m (29.5 ft).
- (b) Without limiting the application of the height regulation in Section 10.4.5(f).3, the height of any carriage house wall, measured from the lowest elevation of grade at the foot of the wall to the lower surface of the eave, or to the top of the wall in the case of a building without eaves, shall not exceed the lesser of 1.5 storeys and 6.5 m (21.3 ft).
- (c) Despite Section 10.4.5(c), the parcel frontage may be less than 16.0 m (52.5 ft) for parcels on a cul-de-sac provided that the radius of the curvature along the parcel frontage is less than 160 m (524.9 ft) and the arc length along the parcel boundary is at least 12.0 m (39.4 ft) as illustrated in Figure 10.1.

Figure 10.1 Minimum frontage on a cul-de-sac

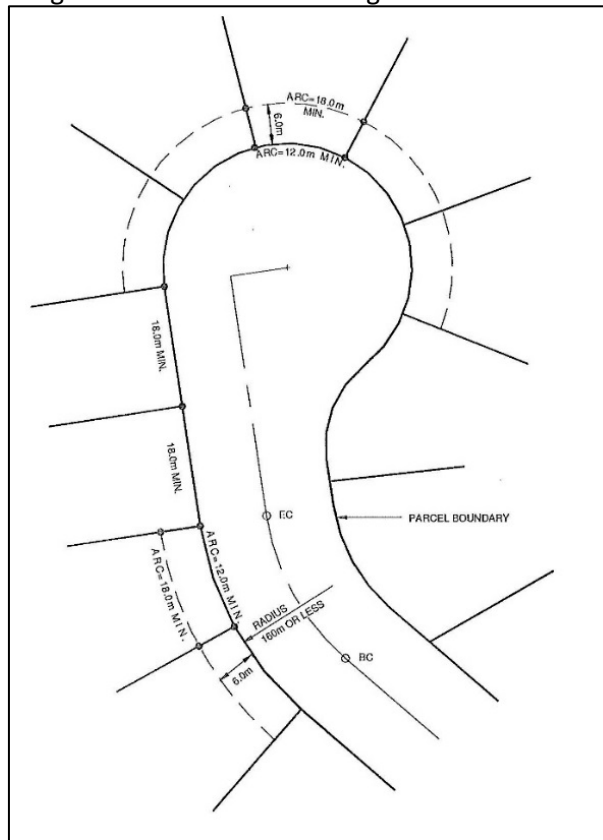

.7 Siting Regulations for Approving Subdivisions

- (a) The regulations requiring a minimum distance between garages or carports having vehicular entry from parcel boundaries or private access easements, that is greater than the minimum distance required for other buildings and structures, and
- (b) The regulations requiring that the siting of a building or structure be determined in relation to the location of a private access easement, if it is closer to the building or structure than the relevant parcel boundary,

shall not apply to any parcel created by subdivision deposited in the Land Title Office before March 13, 2014 provided that the building permit authorizing the construction of the building or structure is issued before March 13, 2019.